

Surveyed by John H. Davis J. C. C. Dec 9th 1859,
Samuel Pollock & Daniel Ferrill sworn as ch. carriers and
corners set from 1 to 2

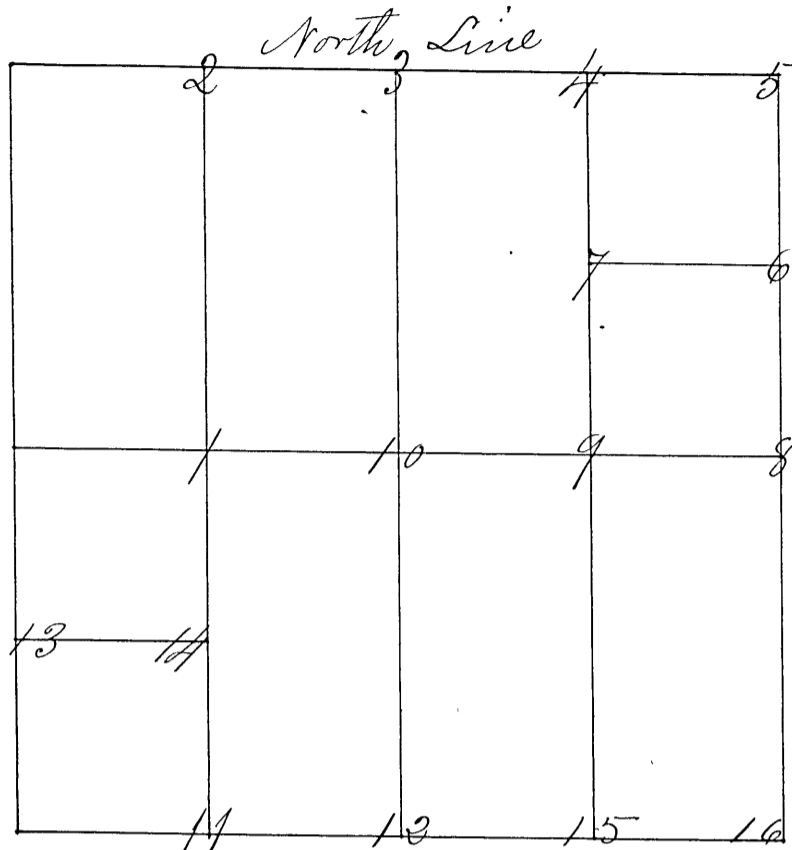

Cor. No 1 Sand Stone 24 inches long

" W. Oak 36 N. 68 W. 128 lbs.

" W. Oak 36 S. 60 E. 102 "

No 2 Sand Stone (T 11) 18 in. long.

W. Oak 24 S 59 W 120 lbs. &

a do. 36 S 69 E 84 1/4 lbs. dist.

Surveyed by S. J. Ferris S. C. C. Feb. 3^d, 4th and 5th
1864, and corners set from 3 to 16. Jas. Ebersele & Jas. Heardorf,
sworn as chain carriers

Cor. No 3 a S Stone T. 11 1/4 S North line

S. Stone N 35° 36' E 35 lbs.

a do. S 37° 15' W 45 "

No 4 S. Stone X

Jack Oak 3 S 16 W 36 "

W. Oak 36 N 35 1/2 W 75 3/4 "

No 5 S. Stone Sec. 2, 3, T 11

a Hickory 12 N. 7 E. 31 "

a Jac. Oak 6 S 7 W 8 1/2 "

No 6 S. Stone marked 1/8 S.

a W. Oak 28 N 81 W 18 1/2 "

a do. 18 S 42 E 9 1/2 "

No 7 S. Stone S. 1/8

a W. Oak 24 N 39 E 54 3/4 "

a do. S 35 1/2 E 37 1/2 "