

Surveyed by John A. Davis Dec. 7th 8th & 9th 1859
 Samuel Pollard & Daniel Ferrill chain carriers & corners set
 from N^o 1st to N^o 5. Feb. 4 & 5th 1862 corners set from 6 to
 11.

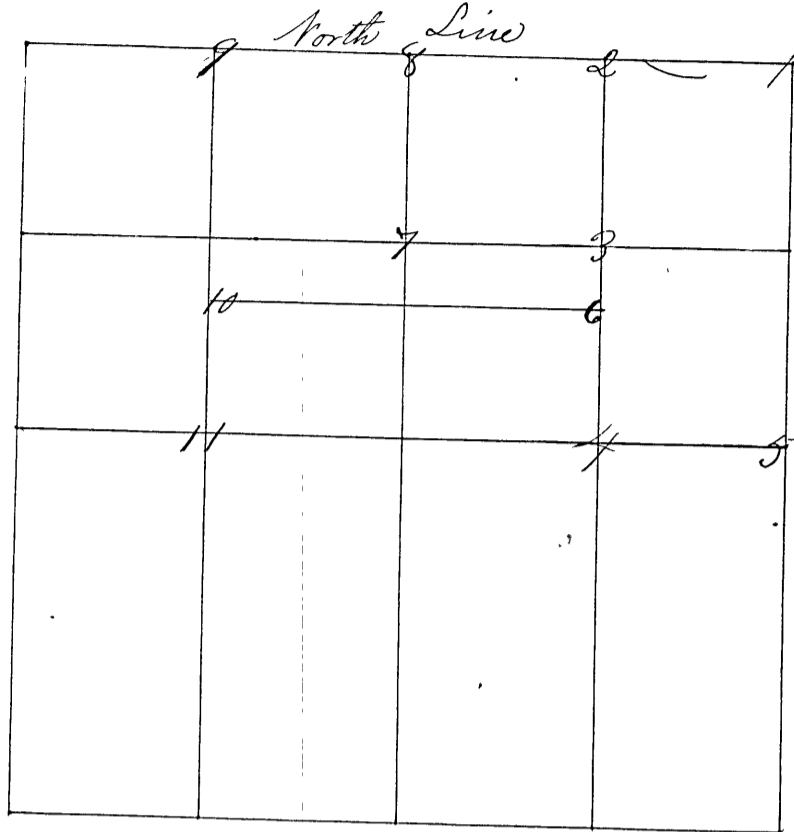

Variation at 4° 40'

- Cor. 1. Sand Stone S. 3, & S. 4. T. 11. R. 6
 W Oak 36 S 66° 30' W. 19 1/2 lks
 a do. 14 S 18° 30' E. 17 1/2 lks
- " 2 Sand Stone 1/8 S & T. 11. R. 6.
 W Oak 16 S 63° E. 70 1/2 lks
 a do. 18 N 74° E. 10 1/2 "
- " 3 Sand Stone 15 in long
 W Oak 36 S 19° 30' E. 43 lks
 a do. 32 S 82° W 113 3/4 "
- " 4 Sand Stone 20 in long
 W Oak 36 N 72° E 123 3/4 lks
 W Oak 20 S 72° W 64 lks.
- " 5 Sand Stone 22 in long 1/4 S
 W Oak 24 N 84° E 108 1/2 lks
 W Oak 24 S 39° 30' E 41 1/4 "
- " 6 Sand Stone 26 1/2 poles South of N.E. cor. S.W. N.E. 1/4
 Jack Oak 10 S 78° W — "
 W Oak 20 N 21° W 42 1/2 links
- " 7 Sand Stone 2 feet long
 Jack Oak 8 N 50° E 50 links
 a do. 20, 4 S 88° E 57 "
- Cor. N^o 8 "Nigger head"
 W Oak 30 S 53 1/2° W 100 lks
- " 9 Sand Stone
 W Oak 30 S 42° E 147 lks.
 Anchors 58 60 E 103 1/2 "