

SECTION Twenty Seven (27) TOWNSHIP Eleven (11)

Surveyed by George V Goshorn, C.S. commenced Dec. 11. 1865 & continued at Sec. 27. & 28 from day till done, finished the 19th Dec chain carriers on Sec. 27. Mr. Bunn and Samuel Owens sworn as Law direct, Patch Sworn as flagman

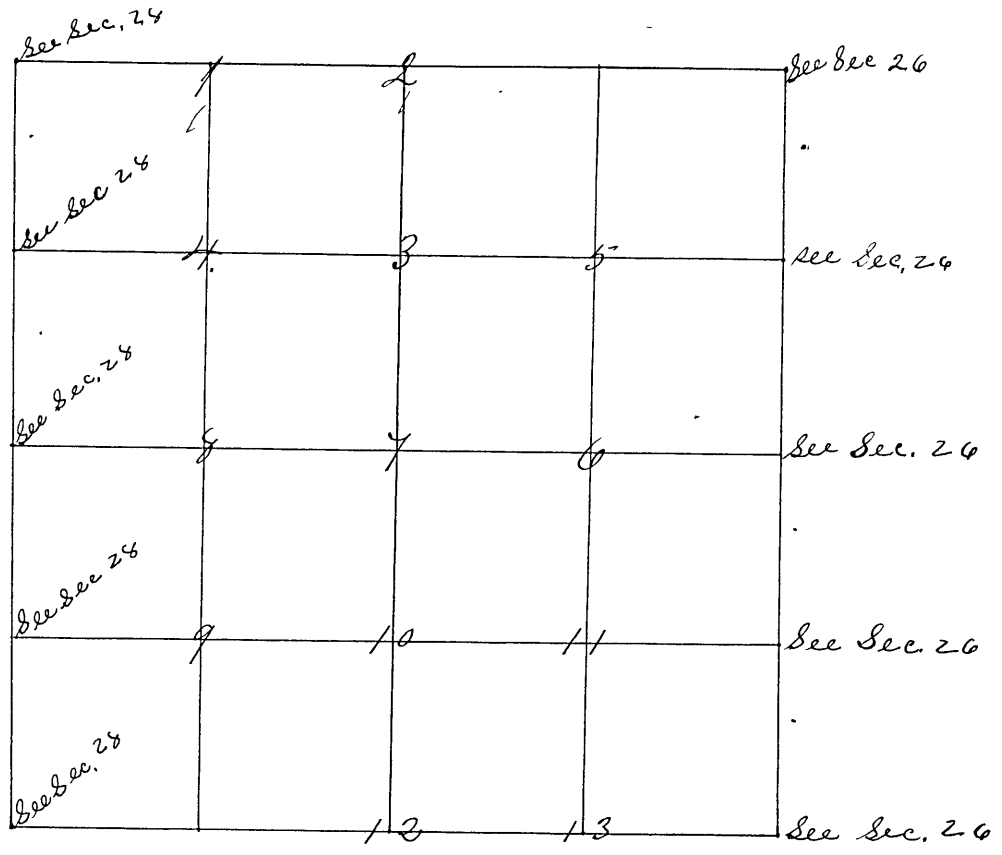

- Cor. No 1 Sec. N. line N.W. 1/4 Sand Stone m 1/16 S
Hickory 15 N 35 E 100 lks.
W. Oak 30 N 58 W 12 3/4 ''
2 N 1/2 W. cor. of Sec. 27. S Stone m 1/16 S. Original old rotten beech stump mark
Apple tree 4 S 10 1/2 W 16 1/4 ''
Sycamore 5 N 1 1/2 W 90 ''
3 cor. E. line N.W. 1/4 S. Stone m 1/16 S.
Beech 25 N 13 W 8 lks.
Blk. Oak 10 S 4 E 6 1/2 ''
4 cor. N.W. 1/4 Sand Stone m 1/16 S
W. Oak 25 S 33 E 16 lks.
Do 25 S 1 E 2 1/2 ''
5 cor. of N.E. 1/4 S. Stone m. 1/16 S
Jack Oak 5 S 60 W 25 lks.
Do. 5 N 22 1/2 W 31 ''
6 cor. N line of S, E. Sand Stone m 1/16 S
Poplar 8 S 36 E 7 1/4 lks.
Beech 20 N 38 W. 69 ''
7 cor. Sec. 27 Sand Stone m 1/4 S,
Bur. Oak 20 S 72 1/2 W 27 1/4 lks.
Elm 20 S 6 W 26 3/4 lks.
8 cor. South line N.W. 1/4 S Stone m 1/16 S,
Jack Oak 12 N 68 W 33 1/3 lks
Do - S 8 1/2 E 3 1/2 ''