

Surveyed by J. H. Davis Nov. 27<sup>th</sup> 1860 & corners 1 & 2 set,  
 Surveyed Dec. the 4<sup>th</sup> 1863. by S. F. Terrell S. C. C. chain carrier  
 Geo. Atkinson. Sanib Waters cor. set from 3 to 7,

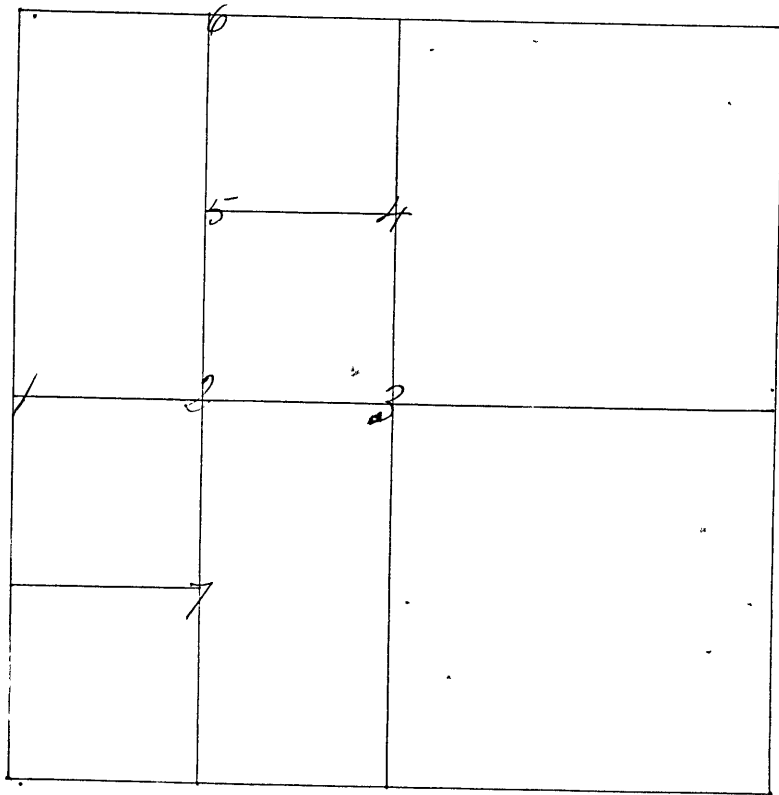

600. No. 1 1/2 Mile cor. on W side Sand Stone 1/4 S Original trees found,

" " Ash 8 N 81 E 74 Links

" " W. Oak 36 N 64 E 56 Links

" " E Sand Stone

W. Oak 40 N 71 E 18 Links

Jack Oak 7 N 36 W 1/2 sks.

J. H. Davis S. C. C.

~~No. 3~~ No. 3 S. Stone 12 long cor. sec. 1/4 S,

" " W. Ash 8 S 83 W 16 3/4 "

" " W. Oak 8 N 43 30 W 24 "

" No. 4 S Stone 12 long x

" " W. Swamp Ash 12 S 64 1/2 W 38 1/2 "

" " W. Burr Oak 24 N 74 E 14 "

" No. 5 S Stone 8 long x

" " W. Maple 16 N 40 W 27 "

" " W. fac. Oak 14 N 55 W 44 1/2 "

" No. 6 S Stone x

" " W. Oak 24 N 49 1/2 W 38 "

" " W. Oak 24 S 71 30 W 39 "

" No. 7 S Stone 12 long x

" " W. Jack Oak 20 N 53 W 88 1/2 W 38 "

S. F. Terrell, S. C. C.