

Surveyed by Wm Herrow Dep. Co. Surveyor aided by John Davis County Surveyor on county line May 2, 3, 4 & 5th 1859 agreeable to notice published in the "Clay County Weekly Democrat" April 14th Vol. 2. No. 19 3. or 1859 Samuel Deore & Oliver Clark chain carriers on Co. line & John Haymaker & Robert Moore flagbearers Levi Moore & John Dutton chain carriers in Sec. 12 Solomon Deore & Nicholas Lowry flag-bearers & markers & John Pillew, chain carrier second in place of John Dutton all sworn according to Law, & Mutual consent of all the parties present in Sec. 12 T12 R6. James Deore marked last day & qualified &

see N.E. Sec. 8
corner of Sec.
11, T13 R6.
for this N.W. S.
corner

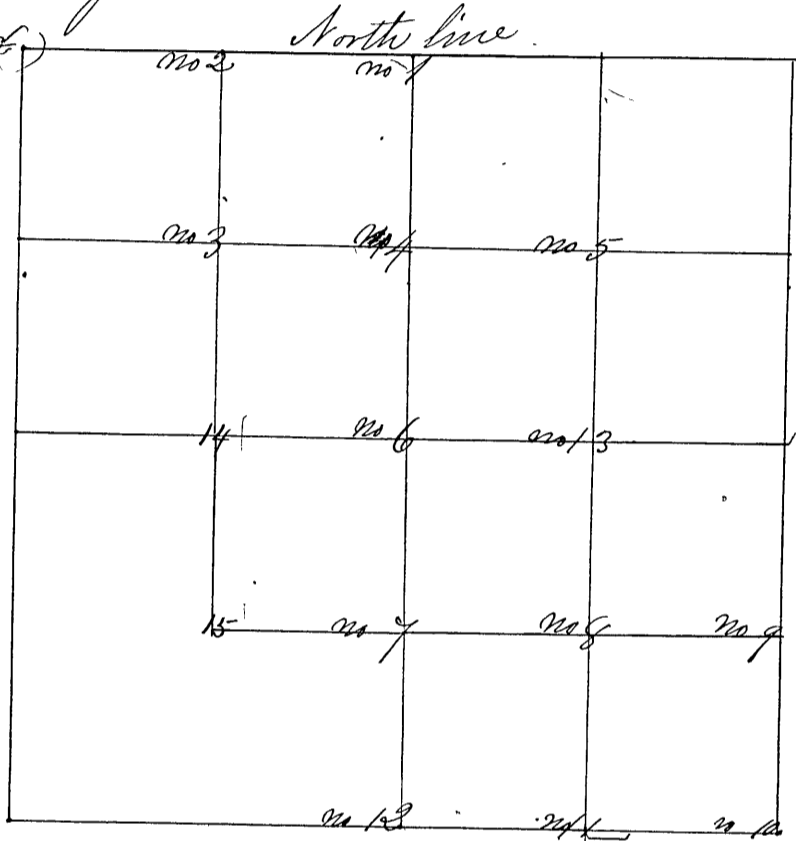

see Sec. no 1 T13 for this corner it being the N.E. S. C.

- Corner No 1 Sand Stone 14 S 25 in North 10 in corner Witness
" " " Sand Stone 12 in East 25 Links
" " " Sand Stone 11 in West 35 Links
- Corner No 2 a Sand Stone 14 in N line N 1/4 m, c.
" " " Sand Stone 14 in S 45 E. 35 Links
" " " Sand Stone 13 in N 45 W 30 Links
- Corner No 3 a Sand Stone 15 in center of N.W. q.
" " " Elm 8 in N 63 1/2 W 54 1/4 Links
" " " Ash 8 in N 12 1/2 W 88 Links
- Corner No 4 a Sand Stone 22 in center N.E. S line N 1/4 on
" " " White Oak 18 N 7 1/2 E 25 lb
" " " White Oak 36 S 7 1/2 W 33 1/4 links
- Corner No 5 a Sand Stone 15 in center N. E. m. S. E. c.
" " " Sand Stone 18 in long West 25 links
" " " Sand Stone 15 in East 25 links
- Corner No 6 a Sand Stone 18 in center Sec. 12
" " " Beech 20 N 6 1/2 W 87 1/4 links
" " " White Oak 40 S 15 1/2 E 42 links