

SECTION Fourteen (14), TOWNSHIP Twelve (12)

Surveyed by J. H. Davis S. C. C. Aug. 13<sup>th</sup>, 14<sup>th</sup> & 15<sup>th</sup> 1860 Robert M. Rose & Geo. Lane chainmen, & John W. Roadenburger flagman sworn as the Law directs & corners set from 1860.

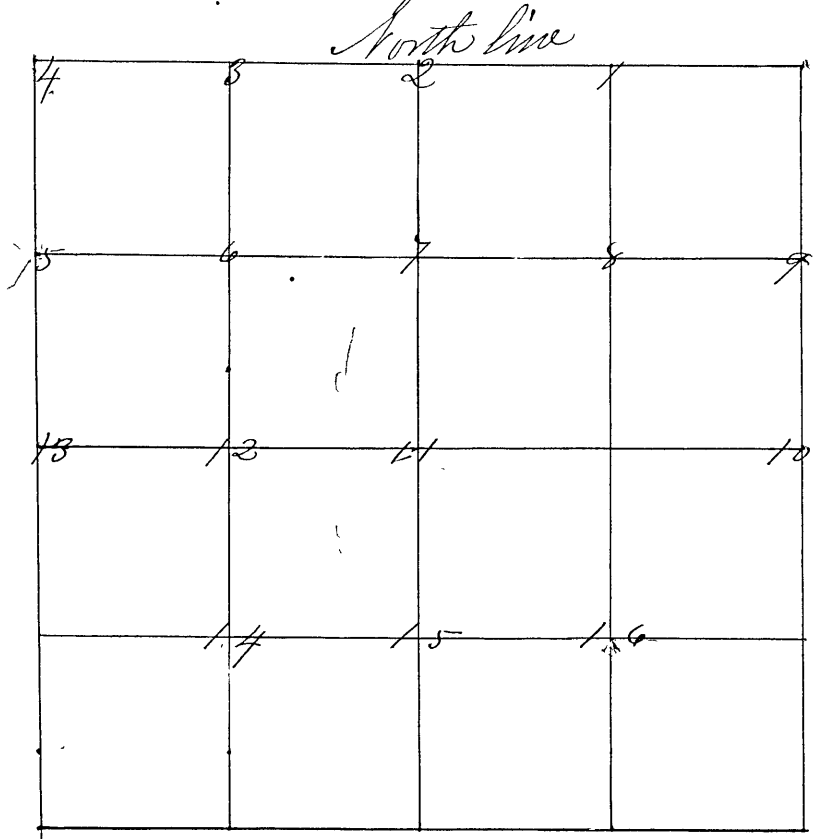

- Cor No 1 Sand Stone 1/8 S
- " " " S. Stone marked x South 25 links
- " " " Do do " " North 25 do.
- " " 2 S Stone 1/4 S 1/2 mile cor on North side
- " " " Sand Stone x South 25 Links &
- " " " a do. do x North 25 "
- " " 3 S Stone 1/8 S
- " " " S Stone x North 25 links &
- " " " do do " South 25 "
- " " 4 S. Stone S 10 S 11 S 14 S 15
- " " " S. Stone x N 45 E 35 links &
- " " " a S. Stone x S 45 W 35 "
- " " 5 S. Stone 1/8 S
- " " " S. Stone x East 25 links &
- " " " a S Stone x West 25 "
- " " 6 Sand Stone 1/8 S
- " " " S. Stone x East 25 Links &
- " " " a. do. do. " West 25 "
- " " 7 Sand Stone 1/8 S
- " " " S. Stone x East 25 Links &
- " " " a do x West 15 "
- " " 8 Sand Stone 1/8 S.
- " " " S Stone x South 25 links &
- " " " a do. x North 25 "
- " " 9 S Stone 1/8 S
- " " " S Stone x West 25 links &
- " " " a do x East 25 "