

Surveyed by John H. Davis March 5<sup>th</sup> 6<sup>th</sup> & 7<sup>th</sup> 1861 & corners set from 1 to 12  
 For later Survey see page 426

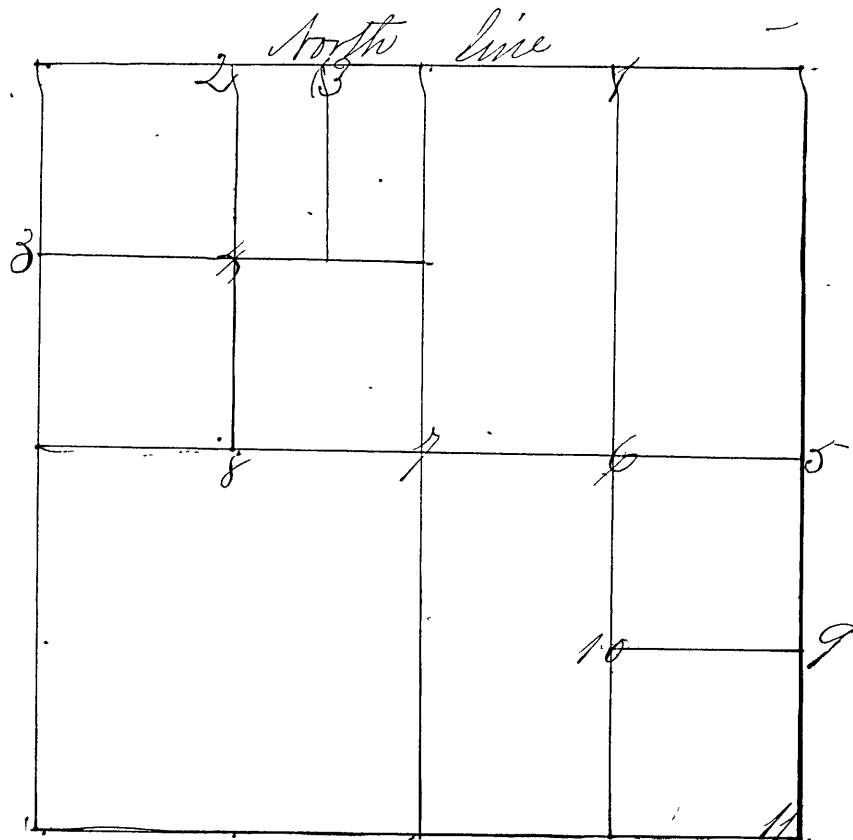

- Cor No 1 Sand Stone 1/8 S (1/2)
- " " " Sand Stone 1/4 N 33 E 28
- " " " a ss. ss. N 32° 35' E 23 "
- " " 2 Sand Stone 1/8 S.
- " " " W Oak 18 S 31 E 32 Sks. &
- " " " a "igger head" North 12 W 28 "
- " " 3 Flint Stone 1/8 S.
- " " " Sand Stone East 26 Sks. &
- " " " a ss. ss. N 66 W 35 1/4 "
- " " 4 Sand Stone 1/8 S.
- " " " W Oak 24 S 34 W 31 1/2 Sks. &
- " " " a S Sand 9 N 84 W 34 1/2 "
- " " 5 S. Stone 1/4 S
- " " " Flint Stone West 26 Sks
- " " " Sand Stone N 22 W 29 Sks.
- " " 6 Sand Stone 1/8 S.
- " " " Sand Stone East 17 Sks. &
- " " " a ss. ss. West 17 "
- " " 7 Center of Sec. S. Stone 1/4 S.
- " " " Sand Stone West 15 Sks. &
- " " " a ss. ss. East 15 "
- " " 8 Sand Stone 1/8
- " " " Red Oak 5 N 50 E 6 1/2 Sks.
- " " " a Sand Stone N 79 W 8 Sks.
- " " 9 Sand Stone 1/8 S.
- " " " Sand Stone S 23 W 9 Sks. &
- " " " a Sand Stone N 63 E 10 Sks.