

Surveyed by J. J. Peyton County Surveyor Jan. 1852nd survey commenced chain carriers and markers placed according to law

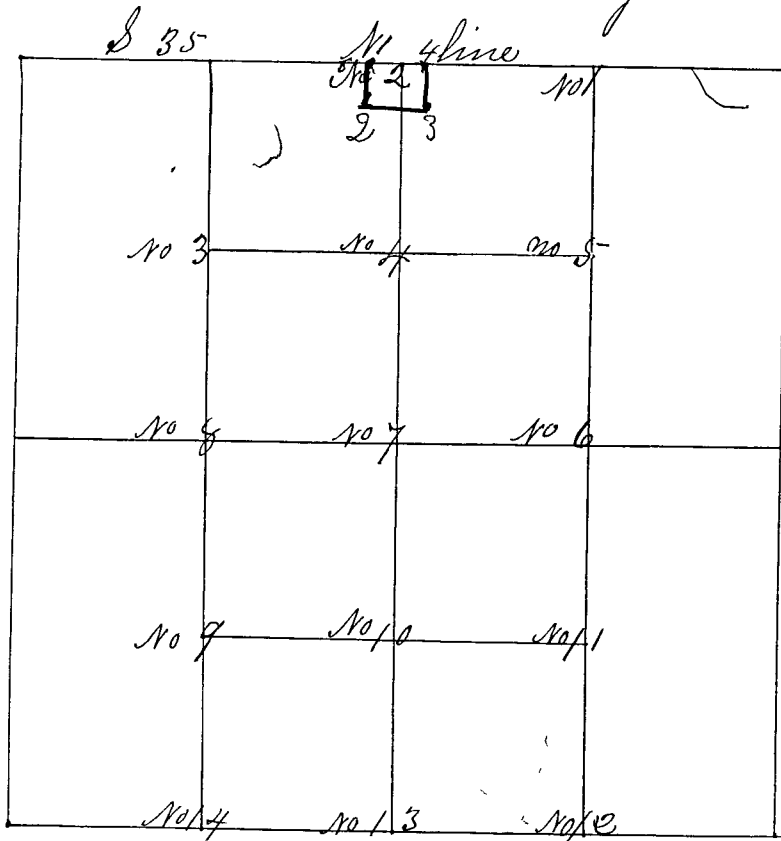

- Corner No 1 1/4 mile N of N.E. cor. Birch 3 S 28 E 60 1/2
- " " " Maple 5 N 48 E 92
- Corner No 2 half mile stake on N. side S. Oak 5 N 68 E 66 1/2
- " " " Ash 2 N 27 W 60 1/2
- Corner No 3 S.W. corner of the N.E. qr of the N.W. qr. Ash 5 N 18 E 29
- " " " Dog 4 N 58 E 94
- Corner No 4 1/4 m N of center W Oak 24 N 81 1/2 E 59
- " " " Ash 3 S 42 W 85
- Corner No 5 S.E. corner of N.W. 1/4 of N.E. qr. S Oak 9 S 28 W 65 1/2
- " " " cherry 6 N 39 1/2 E 58
- Corner No 6 One fourth m E of center W. Oak 30 North 35
- " " " Beech 19 S 74 E 33
- Corner No 7 center of section Apple tree 2 N 35 1/2 E 229
- " " " cherry 2 1/2 S 41 W 107
- Corner No 8 1/4 mile W of center W Oak 22 North 17
- " " " cherry 5 S 38 E 49
- Corner No 9 N.W. corner of S.E. 1/4 of S.W. qr. R Oak 8 S 47 E 31
- " " " B Oak 4 North 41 1/2