

Surveyed by John J. Peyton Deputy County Surveyor, February 7th 1851 and corners set from 1 to 4 agreeable to said second survey made March 17th 1853

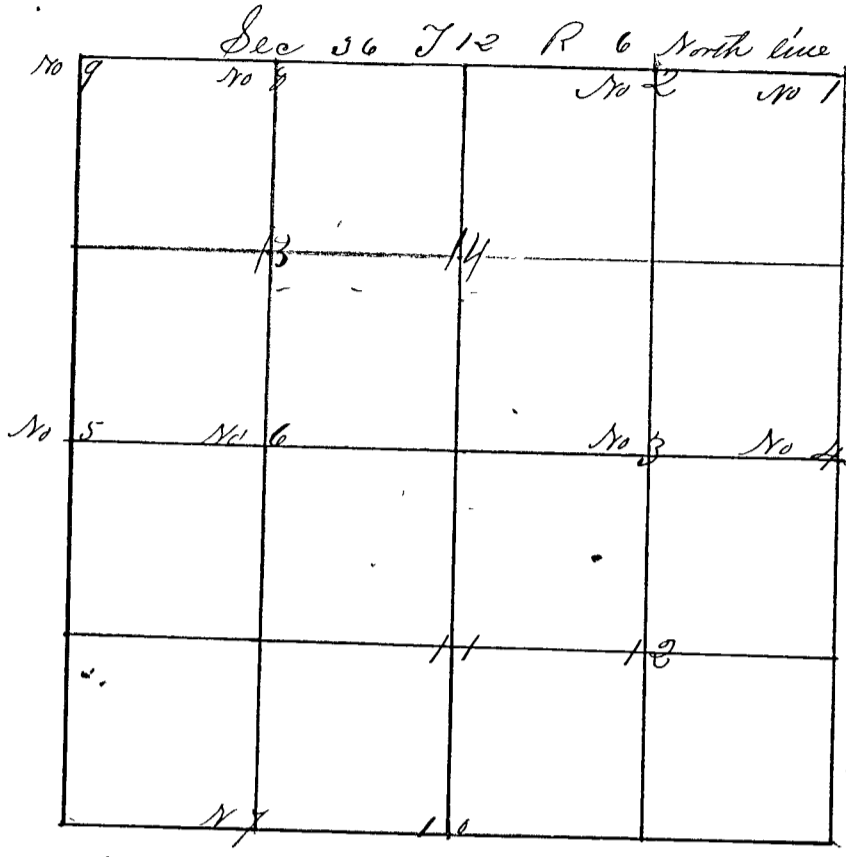

- Corner No 1 North East corner of Section 36.
Witness Trees Jack Oak 13 N 66 W 67 Links
Elm 5 S 56 W 90 Links
- Corner No 2 North Sec. line East 1/4 m corner
Witness Trees, Beech 18 S 14 E 45 Links
Beech 10 N 62 E 55 Links
- Corner No 3 Center E & W line E 1/4 m corner
Witness Trees Jack Oak 5 S E 47 Links
White Oak 14 N 45 E 140 Links
- Corner No 4 1/2 mile stake on East Section line
"Witness Trees" Beech 20 N 47 W 41 Links
Beech 22 S 25 E 28 Links
- Corner No 5 1/2 mile post on W. side Sand Stone marked 1/4 S
Sugar 20 S 60 E 27 L
S. Oak 4 S 43 W 20 "
- Corner No 6 1/4 mile E of No 5 Sand Stone marked 1/8 S
Beech 18 South 12 E
W. Oak 24 N 5 E 71 "
- Corner No 8 One fourth mile E of N W corner
Elm 12 N 29 1/2 W 118
W. Oak 20 S 21 E 65 1/2
- Corner No 9 N.W. corner (Surveyed in the Spring of 1851)
S. Gum 15 S 14 W 150 "
Elm 4 N 50 E 74 "
- Corners 10, 11 & 12 set by P. J. Sutter S. L. by consent of parties present April 22 1868