

Surveyed by P. J. Luther Surveyor Co. April 28 & 30 1868 after three weeks notice in the Brazil Manufacturer and Miner. Chain carriers on E line same as Sec. 2 on West line Peter Wilson and Samuel Wilson flagman, James F. Brown atman Abel McQueen all sworn as Law directs adjourned in June 1868 corners 1 & 2 set on West line

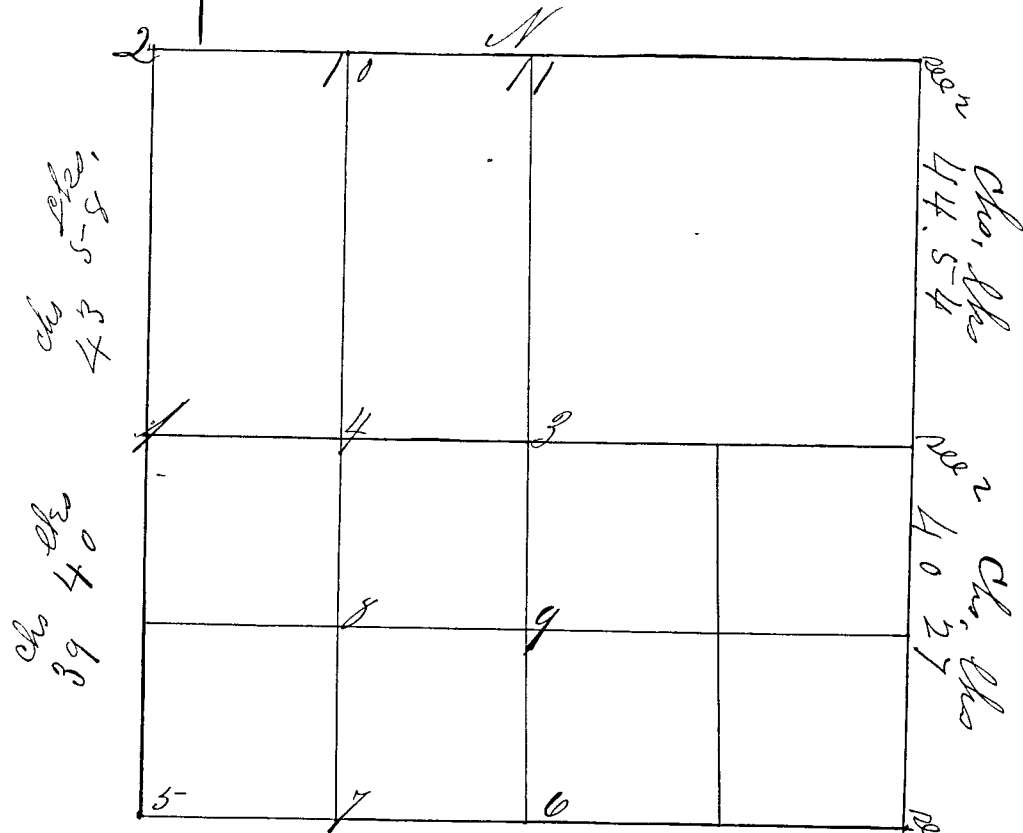

Corner 1 We found C. B. a S. S. 34 in m 14 S 3.8-4 from which
 " " " a S 815- East 25 Sk.
 " " " a S 5025 West 25 "
 Cor 2 N.W. found 'C.B.' (m lap) a S S 32 in m 83.4 7/13 R 6
 a S, S, 15 S 45-8 50 "
 a S, 12 S 45 W 50 "

Further Surveyed by Peter J. Luther Surveyor Co. August 4th to 5th 1868 after three weeks notice in the Brazil "Manufacturer and Miner" Henry Bell & R. Scallcup chainmen, workman all sworn as the Law directs and corners set from 3 to 11

Corner No 3 a Sand Stone 24 m 1/4 cen. of Sec from which
 " " " a Stone N 39 W 39 1/2 Sk
 " " " a do. S 40 E 30 "
 " " 4 a Sand Stone 24 m 1/8 from which
 " " " a Stone North 30 1/2 "
 " " " a do. South 22 "
 " " 5 a S. Stone 17 m S 3.4, 9.10 7/13 R 6. S. 2 cor. found C.B.
 " " " a Stone S 42 W 42 "
 " " " a do. S 45 1/2 E 40 "
 " " 6 a Sand Stone 24 m 1/4 S 1/2 found (Old roots) -
 " " " a Stone N 37 W 29 1/2 "