

South 1/2 mile corner perpetuated by Wm Harrow Dep. Co. Surveyor. by consent of parties Sept 9th 1857 chain carriers John Benton and Surveyor Wm Harrow for said corner

See Record No. 2 P. 14

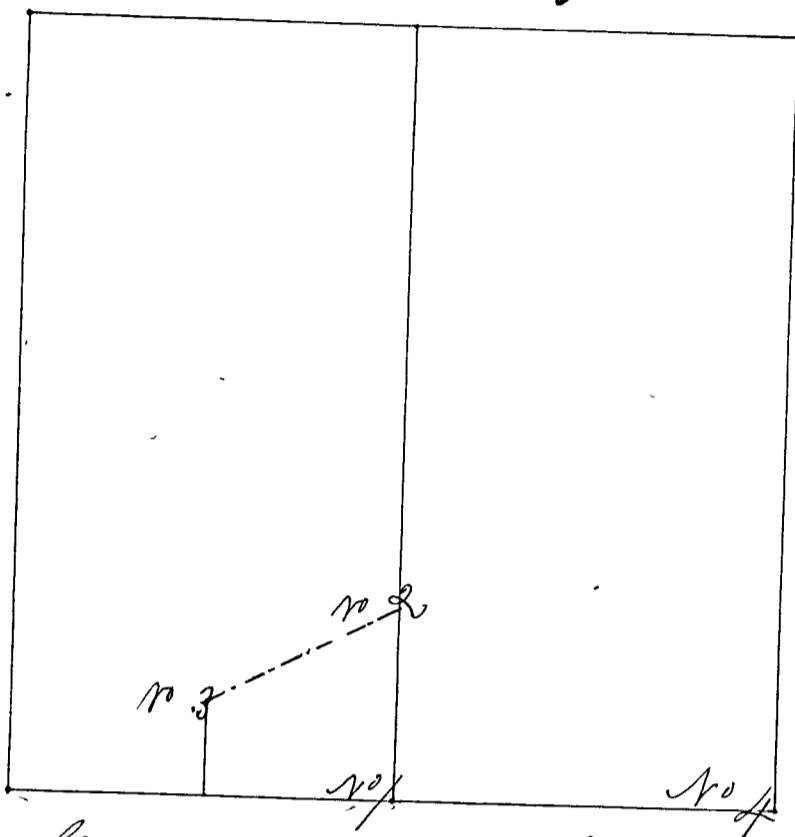

See page 620.

Corner No 1 a Stone 12 in long South 1/2 mile corner.

Wit Trees Fork White Walnut 4 in dia N 4 2 08/100 L.

North 1/2 mile corner of Section 31 Cong. Township No 12 N R 6 W East with Town. line fourteen poles & 7 links (14 Poles 7 l)

Corners Nos 2 & 3 perpetuated by mutual agreement all parties present Elisha Hadden & Robert Stewart chain carriers sworn and corners perp. Sept 15th 1857.

Corner No 3 a Stone on center N & S line 80 poles North of South line or corner no old

" " " " Wit Trees Sugar 5 N 01 W 4 7/2 L

" " " " Beech 30 S 60 1/2 E 64 3/4 L.

Corner No 3 a Stone on center N & S line of South west quarter of Sec. 31. 36 Poles N of South line of said Section

" " " " Wit Trees Elm 1 1/2 in N 83 W 6 Links

" " " " Elm 2 " S 83 1/2 E 11 3/8 Links

Corner No 4 a Stone (lettered) S. E. Sec. corner

Perpetuated March 8th 1859 by Wm Harrow & mutual consent parties present & acted in per old or original trees down and fast decayed

Wit. Trees Beech 18 N. 7.1 E 37 Links

Forked White Walnut 10 N 5 E 44 3/4 L.