

Surveyed by Wm. Henson deputy surveyor to John & Payton C. S. The bearings of witness trees taken at 5th 2nd sq. variation West and notice given in a paper printed in "Terre Haute Pa." Apr 13th 1840 according to the then existing law corners No 1-2 & 3.

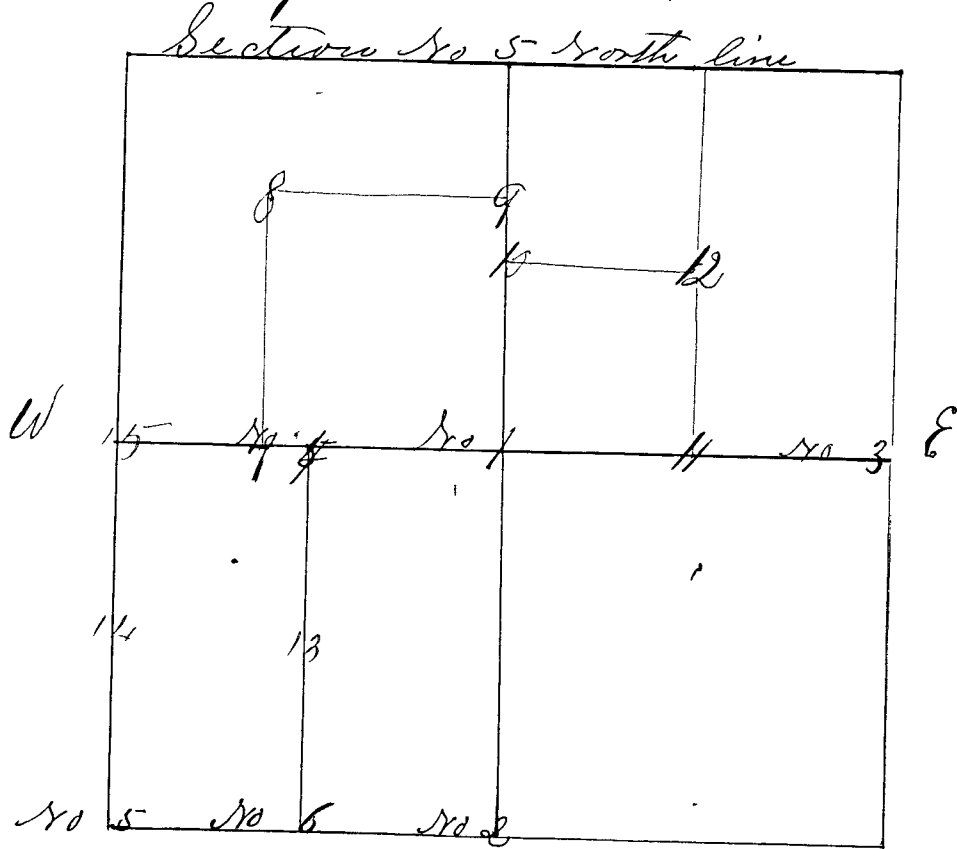

- Corner No 1 a Stone center of Section
- " " " Hickory 6 in N 5 2 1/2 E 178 Links
- " " " Hickory 12 S 85 W 202 Links
- Corner No 2 a Stone South 1/2 mile South original witness trees
- " " " Hickory 12 S. 40 E 18 Links
- " " " Black Oak 18 S 66 W 48 Links
- Corner No 3 a Stone East sec line 1/2 mile corner (original witness tree)
- " " " White Oak 24 S. 70 W 232 Links
- " " " Black Oak 8 S 34 1/2 W 941 Links
- Corner No 4 5 & 6 set agreeable to notice published in the "Brazile Weekly News"
- See sec 7 T 11 R 7 W for every necessary information survey done the same time
- Corner No 4 a Stone E. & W. center line N. & S. line
- " " " White Oak 30 S 36 W 92 Links
- " " " Black Oak 5 S 74 E 46 1/2 Links
- Corner No 5 South West section corner the stone see sec 7
- " " " Hickory 10 S 1 3/4 E 41 1/2 Links
- " " " Hickory 5 N. 22 1/4 E 42 Links
- Corner No 6 a Stone South section line. W. 1/4 M. E.
- Black Oak 6 N 47 E 53 Links
- Black Oak 3 S. 41. W 41. Links