

SECTION Seven (7) , TOWNSHIP Eleven (11)

Surveyed By Mr Heron Deputy County Surveyor Survey  
 commenced in Sections Nos 5, 6, 7 & 8 January 12th 1857  
 agreeable to notice Published in the "Brazil weekly news"  
 Dec. 15<sup>th</sup> 1856 No 29 Vol 1-3 times and lines run and corners  
 perpetuated according to variation of said lines on  
 chain carriers and markers &c. sworn John McGuffey, Mon Turner  
 George Rector David Holsten & Mon Curry. Mon Heron jr. John  
 Rector, John Conaway & J. A. Rardin all by consent of  
 those present the chain carriers were in general used as  
 as sights & markers. (Survey tested May 7th 1857 and found correct.)

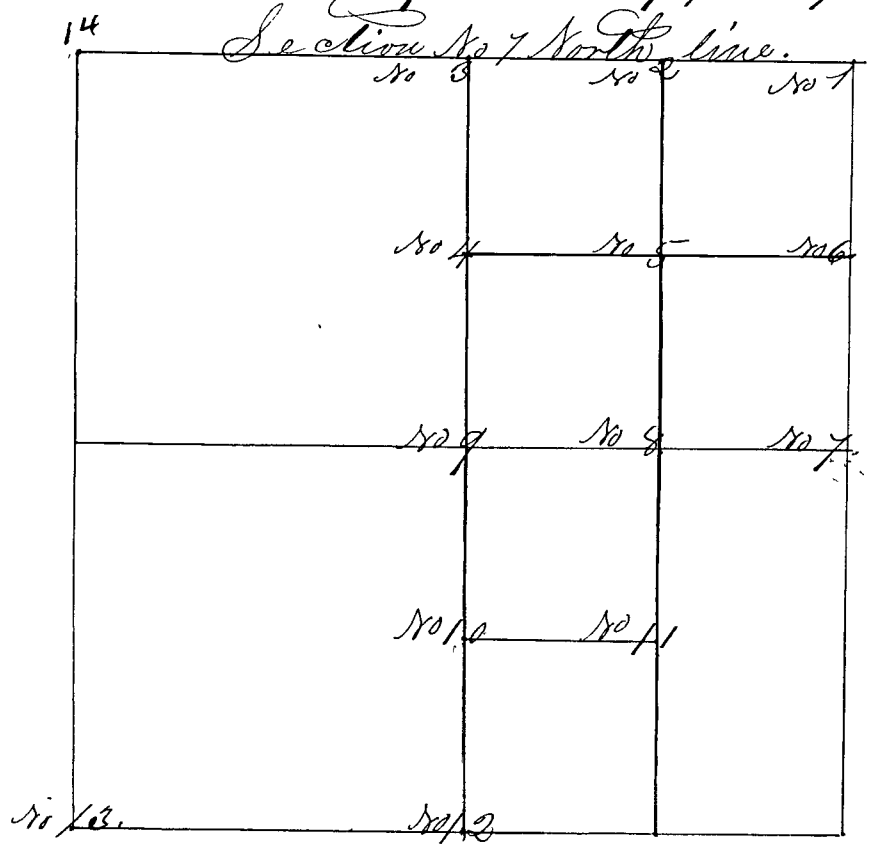

- Corner No 1 a Stone North East Sec. corner
- " " " Mt. Trees Hickory 10 S 1 3/4 E 4 1/2 Links
- " " " Hickory 5 N 22 1/4 E 4 2 Links
- Corner No 2 a Stone N. Sec. Line East 1/4 mile corner <sup>(each way)</sup> 80 Poles & 2 Links
- " On Section line equal distance, or half way between
- " Corners No 1 and No 3. 80 Poles & 2 Links each way no timber nears
- Corner No 3 a Stone North 1/2 mile corner. bet 6 & 7
- " " " Black Oak 10 S 7 3/4 E 10 1 Links
- " " " Black Oak 8 N 16 E 5 5 Links
- Corner No 4 a Stone center. N & S line. N 1/4 m corner
- " " " Black Oak 4 N 64 E 5 2 Links
- " " " Black Oak 3 S 64 E. 4 5 1/2 Links
- Corner No 5 a Stone Center North East quarter S 7.
- " " " in the center between corners No 2 & 8 and corners 4 & 6
- " " " No timber nears about 80 Poles each way
- Corner No 6 a Stone East Section line N 1/4 mile corner
- Jack Oak 3 S 7 E 5 5 Links
- Hickory 6 S 66 3/4 E 16 1 Links