

Surveyed by Wm Herrod Deputy Co. Surveyor to John Peyton Co. surveyor. The bearings of witness trees taken at 5 deg variation West March 11<sup>th</sup> 1840 for corners from 1 to 8 no 9 perpetuated Dec. 1840

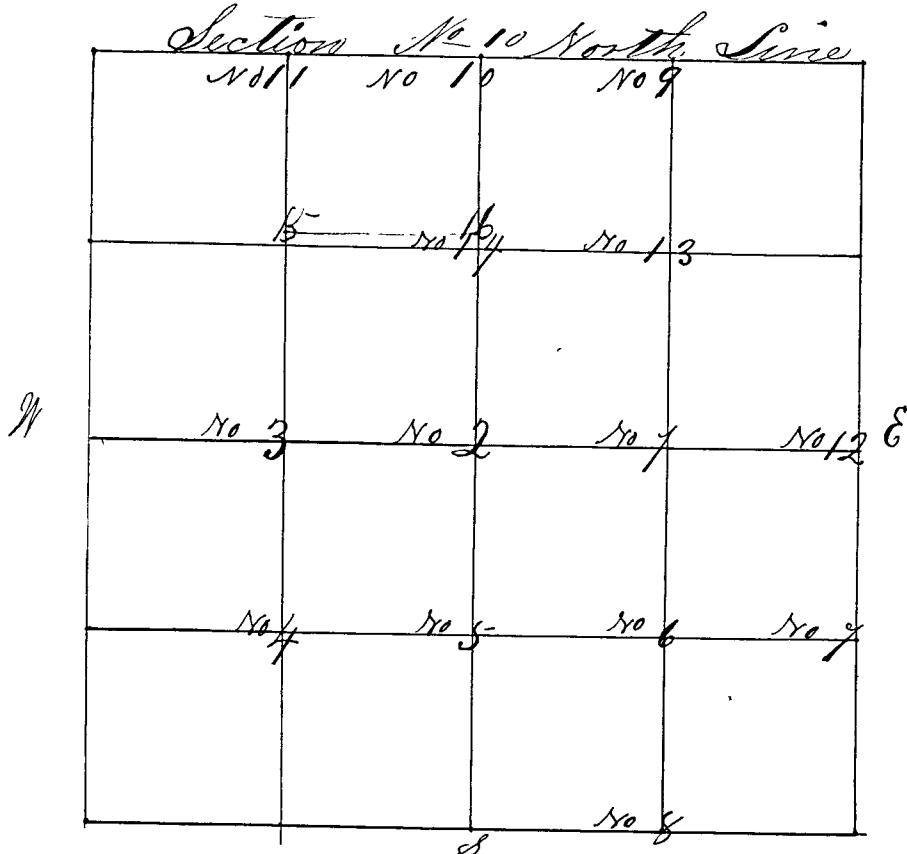

- Corner No 1 a Stone;  $\frac{1}{4}$  m. c. center east and west line  
 " " " (Witness Trees) Hickory 15 N 88  $\frac{1}{2}$  deg. W 216 links
- Corner No 2 a Stone; center of Section  
 " " " White Oak 20 N 24 E 208 links  
 " " " Jack Oak 1  $\frac{1}{2}$  S 85 W 68 links
- Corner No 3 a Stone;  $\frac{1}{4}$  m. c. center E & W line  
 " " " Hickory 10 N 34  $\frac{1}{2}$  W 41 links  
 " " " Hickory 5 N 89  $\frac{1}{2}$  E 75 links
- Corner No 4 a Stone; center of South West quarter  
 " " " Jack Oak 2 N 82 W 24 links  
 " " " Hickory 4 S 63  $\frac{1}{4}$  E 93 links
- Corner No 5 a Stone; South  $\frac{1}{4}$  mile c. on center N & S line  
 " " " Jack Oak 2  $\frac{1}{2}$  S 79 W 49  $\frac{1}{2}$  links  
 " " " Hickory 5 S 50  $\frac{1}{2}$  E 40  $\frac{1}{2}$  links
- Corner No 6 a Stone; center of South East quarter  
 " " " Jack Oak 14 N 39 N. 107 links  
 " " " Jack Oak 6 S 42  $\frac{1}{2}$  E. 72 links
- Corner No 7 a Stone; East Sec. line South  $\frac{1}{4}$  m. c.  
 " " " Black Oak 20 S 33  $\frac{1}{4}$  W 25 links  
 " " " White Oak 20 N 18 N 77 links
- Corner No 8 a Stone; South. S. line  $\frac{1}{4}$  m corner  
 " " " White Oak 12 - 30  $\frac{1}{4}$  E 68 links  
 " " " Hickory 6 N. 83  $\frac{1}{4}$  W. 43 links
- Corner No 9 a Stone; N. S. line E.  $\frac{1}{4}$  mile corner.  
 Elm 10 N. 82 W. 110 links