

SECTION *Twinsten* (19), TOWNSHIP *Clewin* (11)

Surveyed by *Wm. Starrow* Deputy Co. Sur. for *J. J. Peyton*  
 March 15<sup>th</sup> 1854. Lines established and corners perpetuated var-  
 iation same as lines from 4 1/2 to 6 sec. west. no 1 to no 11 in.

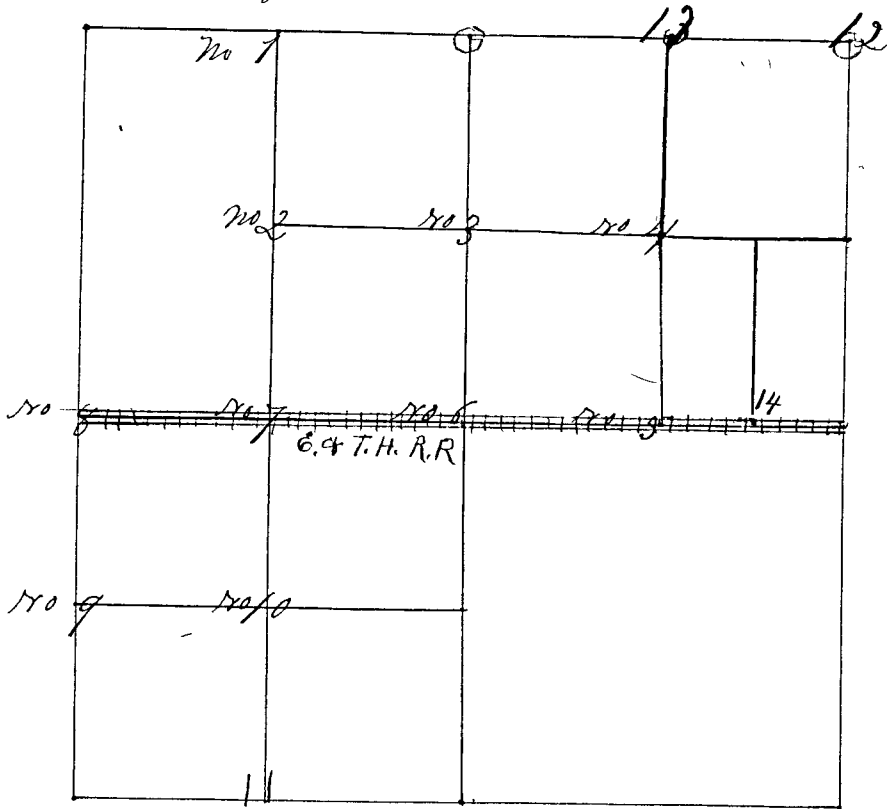

- Corner No 1 N. S. line W 1/4 m corner a Stone  
 " " " Whit Trees, Black Oak 5 N 3. E 7 7/8 Links  
 " " " Hickory 5 S 8 2/3 W 110 Links
- Corner No 2 a Stone; center N. W. q. section  
 " " " Black Oak 2 S 11 E 32  
 " " " White Oak 11 S 81 E 10
- Corner No 3 a Stone; center N & S. L. 1/4 m. c.  
 " " " Hickory 12 S 7 W 2 7/2 L.  
 " " " Post Oaks S 80 1/2 E 249 L
- Corner No 4 a Stone; center of N. E. q. section  
 " " " Hickory 5 S 58 E 21 L.  
 " " " Hickory 4 S 54 W 16 1/2 L.
- Corner No 5 a Stone; center E & W. line E 1/4 m c  
 " " " White Oak 18 S 75 E 9 L.  
 " " " White Oak 4 N 16 1/2 W 19 L.
- Corner No 6 a Stone center of section no. 19  
 " " " Jack Oak 1 1/2 S 1 E 7 1/2 L.  
 " " " Hickory 11 N 82 1/2 E 196 L
- Corner No 7 a Stone center E & W. line W 1/4 m. c.  
 " " " White Oak 5 S 79 3/4 E 36 L.  
 " " " White Oak 4 N 25 1/2 E 4 1/2 L
- Corner No 8 a Stone marked 1/2 N. S. Line 1/2 m. c.  
 " " " Black Oak 4 N 67 3/4 E 55 L  
 " " " Black Oak 8 S 89 1/2 W. 71 L.
- Corner No 9 a Stone N. S. line S 1/4 m. c.  
 " " " Black Oak 10 S. 77 1/2 W. 95 1/4 L.  
 " " " White Oak 2 S 22 1/2 E 8 L.