

SECTION *Twentyfour* 24, TOWNSHIP *Eleven* 11

Surveyed by John H. Davis S. & C. Feb. 11th 1862
noted by pub. in "Way Co Dem." & corners set from 1 to 5-

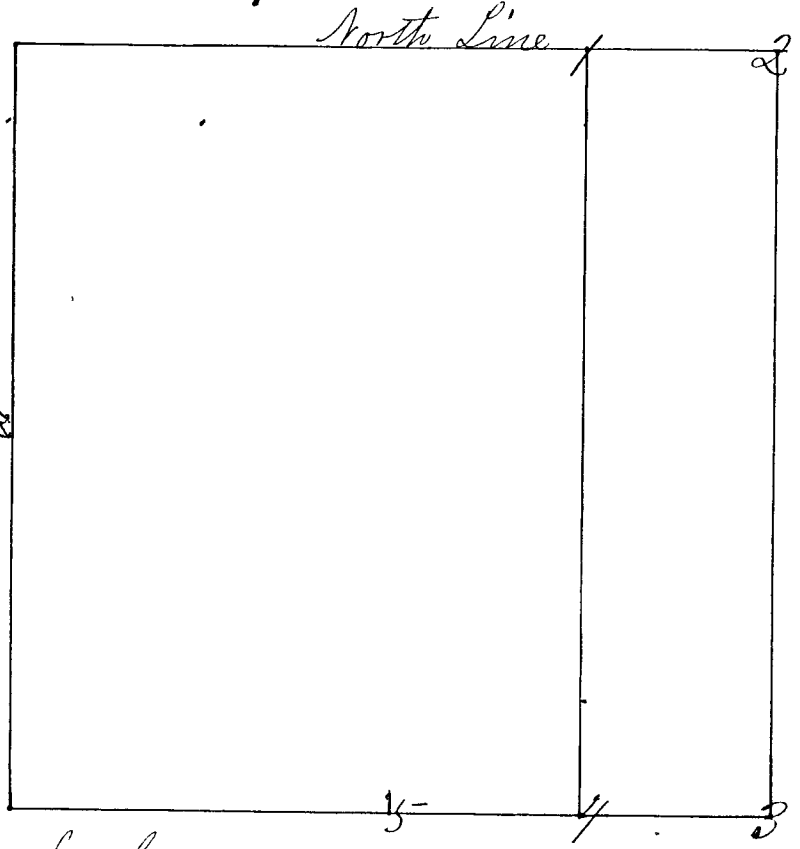

- Cor. No 1 Sand Stone.
- " " " S. Stone South 25 Links
- " " " do, do, North 25- " in line
- " " 2 Sand Stone S. 138 24
- " " " Witness cor. to sec. 18 & 19 T 11 R 6
- " " " South 213 links original Oak & Beech found
- " " 3 S. Stone S 24. S 25-
- " " " Wit. corner to sects 19 & 20 South 259 lks
- " " " Original bearings found.
- " " 4 Sand Stone.
- " " " S. Stone South 25 Links
- " " " do, do, North 25- "
- " " 5 Sand Stone 1/4 S.
- " " " Original Oak - 880 W 10 links found
- " " " No other near ----