

Surveyed by Wm. Ferris Deputy to Surveyor. Survey com. March 23 and finished the 25<sup>th</sup> agreeable to notice in the "Brazil Weekly News" No. 36 Vol. 1<sup>st</sup> 3 weeks. variation same as lines, chains carriers selected by parties present and sworn. Solomon Myers, Jr. Nicholas Didrickes Markar. & Marks man, A. S. Simastro sworn and corners from 1 to 12 set as the Law directs

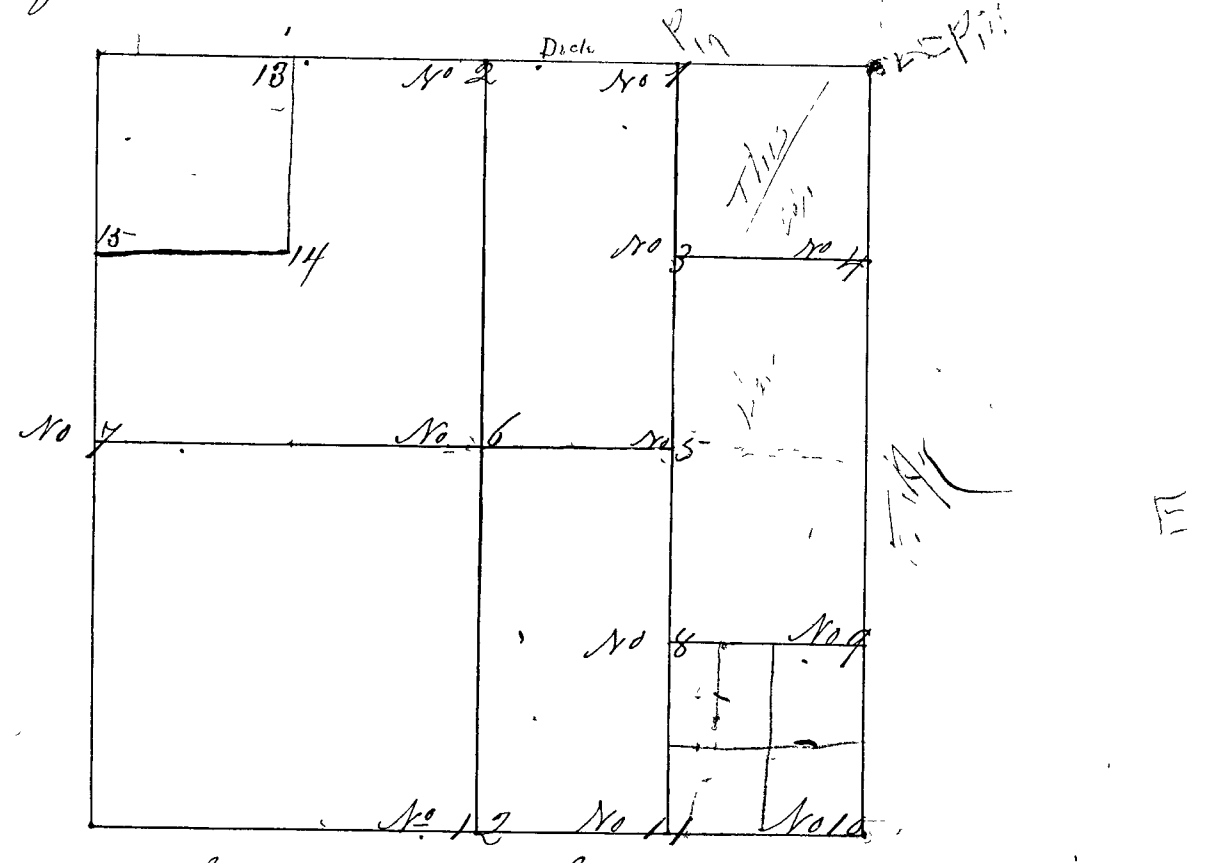

- Corner No 1 a Stone N sec. line E 1/4 mile cor.
- " " " 'White Trees' Hickory 20 N 50 1/2 W 79 L.
- " " " Stone E 1/4 m. c. sec. 36 S. line T 13 R 7 W East <sup>links</sup> 25-
- Corner No 2 a Stone; marked 1/4 S N. 1/2 m. c. sect T 12 R 7.
- " " " Swort Gum 5 N 63 1/2 W 20 links
- " " " Stone South 1/2 m. c. S 36 T 13 R 7 W East with line 52 1/2 l.
- Corner No 3 a Stone center of north East gr.
- " " " Hickory 10 S 49 1/4 E 34 1/2 l.
- " " " White Oak 24 N 54 1/2 E 98 1/2 l.
- Corner No 4 a Stone East line N. 1/4 mile corner.
- " " " Stone West with div. line 50 links
- " " " Stone East of corner, 50 links
- Corner No 5 a Stone center E & W. S. line E 1/4 m. c.
- " " " B. L. Stone 30m North 10 links
- " " " B. L. Stone 18m South 10 links
- Corner No 6 a Stone center sec. 1 T 12 R 7 W.
- " " " Burr Oak 14 S 42 1/2 E 12 l.
- " " " Jack Oak 20 N 38 1/2 W 28 1/2 l.
- Corner No 7 a Stone Mar. 1/4 S. West 1/2 m. corner.
- " " " Stone East 50 Links
- " " " Burr Oak 4 N 58 1/2 W 25 l.
- Corner No 8 a Stone center South East gr. S.
- " " " White Oak 20 N 53 E 33 l.
- " " " H. T. 0 1 20 S 13 1/2 E 6 l.