

Surveyed by Hon. W. Corron Deputy Co. Surveyor, July 6th 1856
Parties present and chain carriers Mr. Graham & E. Loyal, and
marked S. Bailey all sworn as Law directs. Variation same
as East Section line 5-³/₄ N. Corner No 1 Perpetuated.

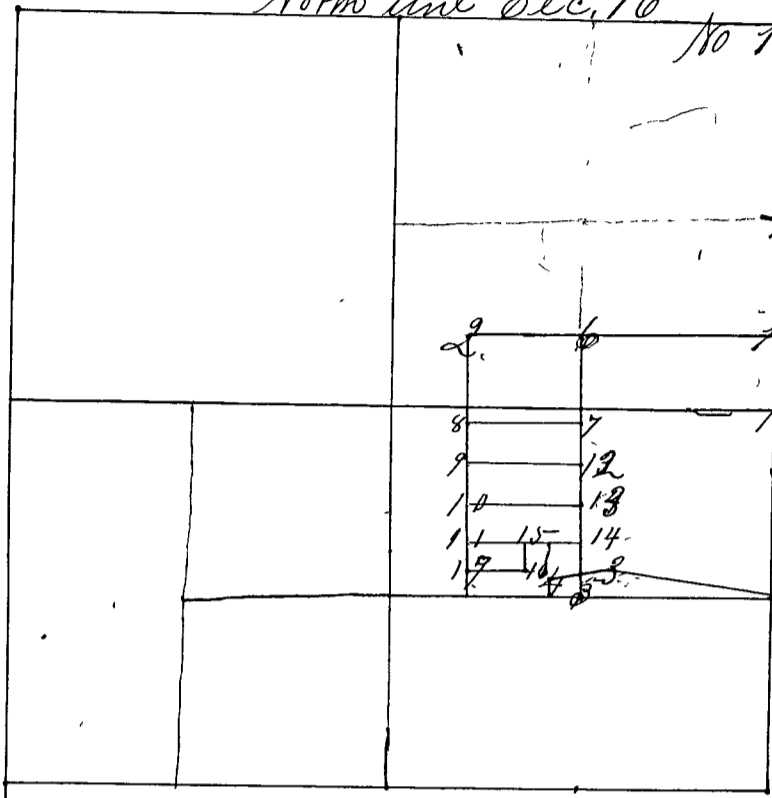

See Page 578
and
(See Record No. 2)
P. 12. J. B. Robertson

Corner No 1 a Stone North East corner

" " " Wit Trees, Ash 11 S 40 1/4 W 33 3/4 links

" " " Jack Oak 10 N 60 1/4 W 81 links

Sec. 16 E. 12. R. 7. further Surveyed by P. J. Suther Surveyor
of Clay Co. survey, commenced April 10th 1867 and contin-
ued from day to day until completed. J. K. Gregory and
Charles A. Lynde chain carriers, James Cook flagman and
Collen Carter a man all sworn as Law directs. All
parties interested present. Corners set from 1. to 19. com-
mencing at 1 again

Cor. No 1 20 Rods 3 Hrs. N of E 1/2 mile cor. a Lime Stone XVI

" " " Witnep, a St. Oak 30 N 71 W 74 lbs.

" " " a Do. 24 N. 67 E. 50 lbs.

Cor. No. 2 a Lime Stone 12 1/2 long 5 9/16 - S of cen. of Columbus St. on

" " " R. R. Switch, a Lime Stone 10 long N 45 W 15 lbs.

" " " a Do. 12 " S 45 W 15 "

Cor. No. 3 a Round S. Stone marked III at 20th W. of proper place

" " " Witnep a Jack Oak 8 N 33 1/2 E 34 1/2 lbs.

Cor. No 4 a Hard S. Stone marked X 7 1/2 Rods North of center of center of
" " " No Beaungs mark. T.S. 8 quarter

Cor No 5 a Lime Stone 16 in marked V E X V I

No trees near.

Cor. No 6 a Lime Stone 44 Rods 8 1/4 lbs E of No 2 marked VI

Witnep a Hickory 12 N 28 W 39 lbs

a Do. 8 N 83 E 52 "