

Surveyed by Hon. Herrow Deputy Co. Surveyor notice published in the "Clay Co. Democrat" according to Law Survey commenced April 19 1858 chain carriers D. Yocum & Jos Robertson markers for straight flag-board John Robertson all sworn according to Law, corners set at a variation of said lines from 1 to 13 inclusive

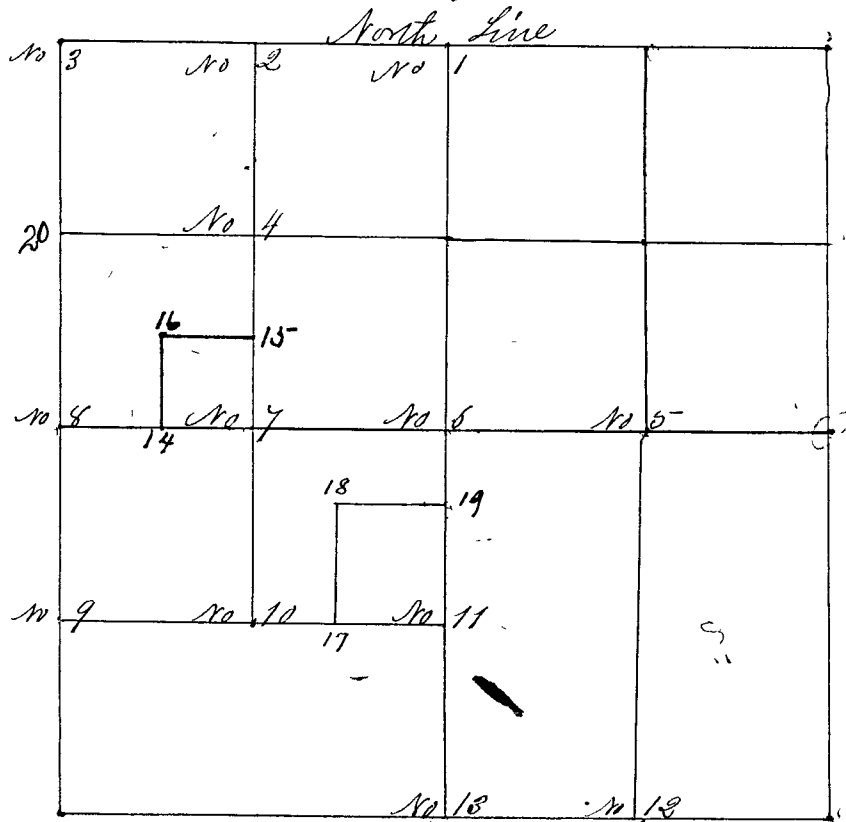

Corner No 1 a Stone, Original trees standing.

Corner No 2 a Stone, N. E. line N 1/4 M corner.

" " " (Wit. Trees) White-Oak 30 N 60 1/2 W 42 1/4 links
 " " " Poplar 7 S 4 1/2 E 24 links

Corner No 3 a Stone let. 35 N. W. Sec. corner,

" " " Hickory 8 N 4 W 5 links
 " " " a Stone South. E 5 links

Corner No 4. a Stone center of N. W. qr. Sec.

" " " Poplar 24 S 70 W 50 L.

See Below # Corner No 5 a Stone center E & W. line E 1/4 M, C.

" " " Hickory 12 S 47 W 34 1/2 L.
 " " " Dogwood 5 S 44 E, 18 L.

Corner No 6 a Stone center of section 35.

" " " Black Walnut 3 S 60 1/4 E 36 1/2 L.
 " " " Mulberry 8 N 43 W 80 1/2 L.

Corner No 7 a Stone, center E & W. line N. 1/4 M, C.

" " " Black Walnut 5 N 86 E. 36 1/3 L.
 " " " Hickory sprout 1 S 56 1/2 W 5 "

Corner No 8 a Stone 1/4 S. W. line 1/2 mile corner.

" " " Sycamore 6 S 10 E, 9 1/2 links
 " " " White Oak 20 N 11 1/2 W 88 L.

Corner No 9 a Stone N. Sec. line South 1/4 M, C.

Sugar 14 S 5 3/2 E 10 1/2 L.