

Surveyed by John H. Davis County Surveyor of Clay Co. Mo. October 25th & 26th 1859 Timothy Harbough and Samuel A. Edmonson sworn as chain carriers corners set from 10th of Notice given by publication in Clay Co. Democrat Vol. 2nd No 42, 3 miles Sept 29th 1859.

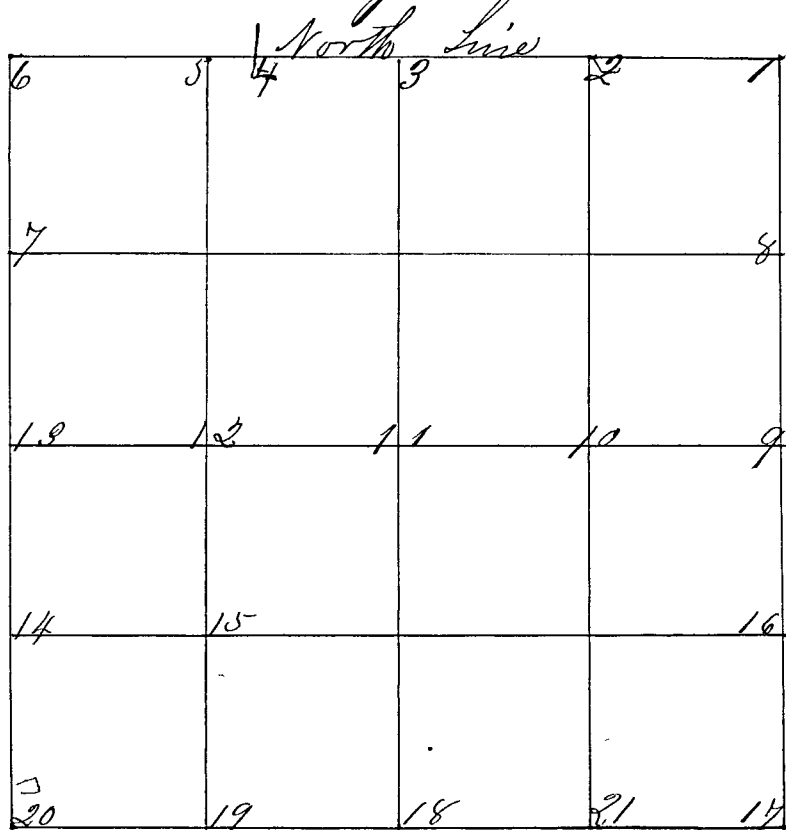

- Corner No 1. N.E. corner of the section S. Stone. S 8. 9 S 10. 17.
- " " " Beech 14 S 49^o E 11 L. &
- " " " Sweet Gum 5 in N 42^o W. 20 L.
- Corner No 2 Sand Stone
- " " " W. Oak 18 N 4^o E. 38 L. &
- " " " Hickory 15 S 53^o E 70 L.
- Corner No 3 1/2 mile corner on North side S Stone marked 1/4 S
- " " " W. Oak 6 S 15^o W. 39 1/2 L. &
- " " " W. Oak 48 N 39^o E 60 1/2 L.
- Corner No 4 Sand Stone E of 1/4 mile corner
- " " " Water Oak 6 N 24^o W 35 1/2 L. &
- " " " Hickory 5 S 26^o W 60 1/4 L
- Corner No 5 Sand Stone
- " " " Hickory 15 S 12^o E 42 3/4 L. &
- " " " Beech 16 S 12^o W 57 L.
- Corner No 6 Sand Stone S 7. 8 S 17. 18 N corner of the Sec original witness found.
- " " " Sycamore 2 in. S 40^o W 66 L
- " " " No other tree near
- Corner No 7 Sand Stone Middle N.W. 1/4 on West side
- " " " Water Oak 7 in S 64^o W 84 L. &
- " " " Water Oak 6 S 88^o E 67 L.
- Corner No 8 Middle N.E. 1/4 on E. side Sand Stone
- " " " W Oak 20 S 63^o W 36 1/2 L. &
- " " " Water Oaks 5 S 45^o E 29 1/2 L.