

Surveyed by John Sharp Surveyor of Clay County La. March 25th 1857 and corners set from N 1 to Run at 5th.

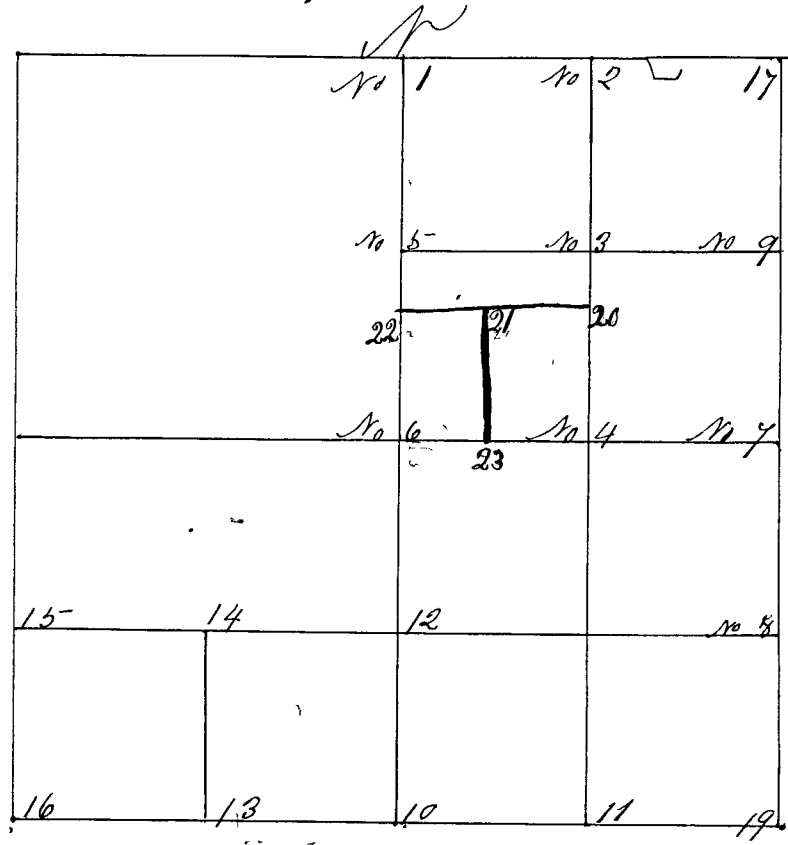

- No 1 Middle of section on North side W. Oak Stake E. 20th line.
 " " Elm 18th North 20 East 76 links
 " " E. W. 20th W. 120 links
- No 2 Middle of N. E. quarter on N side W. Oak Stake
 " " R. Oak 4th W. 141 W. 50 links
- No 3 Middle of N. E. quarter sand stone marked 1/6 on two sides
- No 4 Middle of N. E. quarter on South side sand stone marked 1/6
 " " R. Oak 12th on. S 35th W. 39 links
- * No 5 Middle of N. E. quarter on W. side W. Oak Stake.
- No 6 Middle of section Dogwood Stake
 " " Hickory 18th on S 12th W. 25th line.
- No 7 Middle of section on East side sand stone marked 1/4
 " " B. Gum. 24th on E 20th N 53 links
- No 8 Middle S. E. quarter on E side sand stone marked 1/6
 " " W. Walnut stump 12th on N 32th E 29 links
- No 9 Middle of N. E. quarter on E side sand stone
 " " Hickory 20th on 22th " " " " Links
 " " Although it is marked (through a mistake) N 11 links
- " Surveyed by Geo. W. Goshorn C. S. Dec. 26th 27th 28th 30th 1864
- " chain carriers sworn as the law directs Three weeks publication
- " of notice in "Clay Co. Democrat" this Plat of Sharps not
- " discovered till after survey hence survey taken from original
- " field notes" and corners added to "Plat" and set from 18 to 19
- No 10 Mid of South bound. 100 rather west of mid
 making West 1/2 fractional sand stone 18 in long on 1/4
 "Original Bearing Trees"
 "The above & Plat used"

SEE NEXT PAGE